

## Sheet-Steel Recessed Light Fittings in Flat Version

6012 Series (Zone 1)

6412 Series (Zones 2, 22)

Series 6012 and 6412 light fittings are preferred for use in spraying and painting installations.

- With electronic ballast
- For two-pin fluorescent lamps
- 2- or 4-lamp versions available
- As recessed light fittings in flat version with 80 mm high
- Powder-coated sheet-steel or stainless steel
- Central lock



- All-pole disconnection via NC switch in positive opening operation when glass cover is opened (6012 Series)
- With hinged glass-cover  
With hinged reflector plate

To learn more about B-I-A please visit us at our  
WEB site: [www.BiaGmbH.com](http://www.BiaGmbH.com)



### Selection table

Version	Lamps		Width	Ordering code	Weight
	Lamp wattage	Number of lamps			
	W		mm		kg
6012 Recessed light fitting (Zone 1)	18	2	380	6012/7422-9..1	16,000
		4	480	6012/7524-9..1	24,300
	36	2	380	6012/7442-9..1	26,000
		4	480	6012/7544-9..1	29,900
	58	2	380	6012/7462-9..1	28,300
		4	480	6012/7564-9..1	34,000
6412 Recessed light fitting (Zones 2, 22)	18	2	380	6412/7422-9..0	16,000
		4	480	6412/7524-9..0	24,300
	36	2	380	6412/7442-9..0	16,000
		4	480	6412/7544-9..0	29,900
	58	2	380	6412/7462-9..0	28,300
		4	480	6412/7562-9..0	34,000

### Add. to ordering code

Through wiring	without	6.12/.....0..	
	with 3 cores	6.12/.....3..	
	with 5 cores	6.12/.....5..	
Cable entries	Standard	1 cable gland M 25 x 1,5, 1 cable gland M 25 x 1,5 with integrated plug and 1 plugs M 25 x 1,5	6.12/.....1...
	Special	Specify non-standard entries on writing	6.12/.....9...

#### Note

The light fittings are supplied without tubes and mounting material. These must be ordered separately.

### Technical Data

Version	6012 (Zone 1)	6412 (Zone 2, 22)	
Explosion protection			
Gas explosion protection	⊕ II 2G EEx ed IIC T4	⊕ II 3G EEx nA II T4	
Dust explosion protection	--	⊕ II 3D IP65 T80 °C	
Certificates			
for gas explosion protection	PTB 99 ATEX 2029	applied for	
for dust explosion protection	--	applied for	
Marking	CE 0102		
Rated voltage	AC: 220 V - 10% ... 240 V + 10%; 50/60 Hz DC: 198 V ... 254 V		
Rated current	for light fittings version		
	2 lamp	4 lamp	
	18 W	0,18 A	0,36 A
	36 W	0,33 A	0,66 A
	58 W	0,49 A	0,98 A
Power factor cos φ	cos φ ≥ 0,96 capacitive; additional compensation not required		
Ambient temperature	- 20 °C ... + 50 °C		

## Technical Data

Lamps	Two-pin fluorescent lamps; 26 mm diameter; for holder G13 2 x 18 W; 4 x 18 W; 2 x 36 W; 4 x 36 W; 2 x 58 W; 4 x 58 W	
Protection	IP 65	
Protection class	I (with internal PE-terminal)	
Material		
Housing	Standard	Sheet-steel, powder-coated, colour white, similar to RAL 9016
	Special	Stainless steel 1.4301 (AISI 304)
Gasket	EPDM formed gasket	
Lens	Safety glass	
Central lock	Central locking; glass cover hinged for access	
Connections	Line-up terminals, 0,5 mm <sup>2</sup> ... 4 mm <sup>2</sup> solid / flexible	
Version	6012 (Zone 1)	6412 (Zone 2, 22)
Switch-off	of light fitting on opening power to ballast is disconnected; switching element with 2 NC contacts in positive opening operation of faulty lamp if lamp is faulty, power supply is automatically switched off by the electronic ballast	of light fitting on opening power to ballast is not disconnected of faulty lamp if lamp is faulty, power supply is automatically switched off by the electronic ballast
Cable glands	Standard	1 cable gland M 25 x 1,5 1 cable gland M 25 x 1,5 with integrated plug and 2 plug M 25 x 1,5
	Special	Specify non-standard entries in writing
Mounting	Mounting frames with fixing holes are welded-on. Light fitting is inserted into ceiling cut out and fixed via mounting frame. The frames are flush with the glass cover.	

## Accessories and spare parts

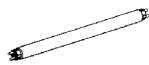
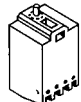
Designation	Illustration	Description	Ordering code	Weight kg
Fluorescent lamps		18 W    1100 lm	<b>4617220</b>	0,100
		36 W    2600 lm	<b>4617210</b>	0,200
		58 W    4100 lm	<b>4617200</b>	0,283
Switch		Switch element 8080/1-3-L, 2 NC	<b>8080006600</b>	0,025

To learn more about B-I-A please visit us at our  
WEB site: [www.BiaGmbH.com](http://www.BiaGmbH.com)



Dimension drawings (all dimensions in mm) - subject to alterations

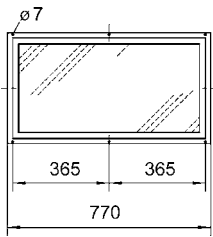

Light fitting

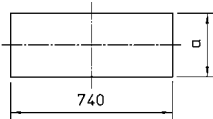

Mounting Cut-Out

Version 18 W

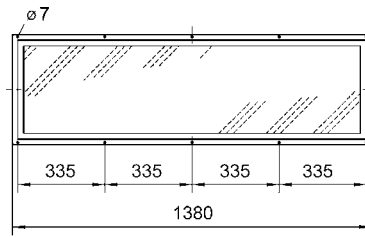

Light fitting

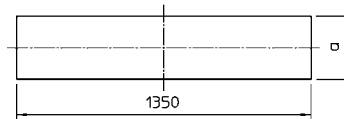

Mounting Cut-Out

Version 36 W

Version	Maße in mm				
Wattage	Number of lamps	b1	b2	b3	a
18 W, 36 W, 58 W	2	380	405	420	390
	4	480	505	520	490

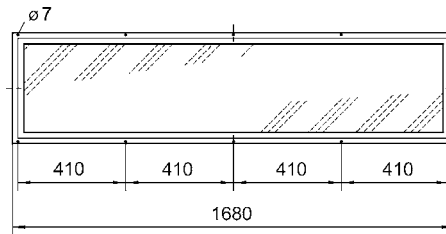

Light fitting

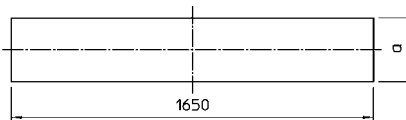

Mounting Cut-Out

Version 58 W

### Sheet-steel recessed light fittings in flat version 6012 and 6412

We reserve the right to make alterations to the technical data, weights, dimensions, designs and products available without notice. The illustrations cannot be considered binding.

To learn more about B-I-A please visit us at our  
**WEB site: [www.BiaGmbH.com](http://www.BiaGmbH.com)**

