

Light Fitting for Fluorescent Lamps

6600 Series (Zones 2, 21, 22)

Series 6600 light fittings are useable for normal lighting, but also as group or centrally-supplied emergency light fitting.

- Explosion protection to EN 50 021 and EN 50 281
- Can be used
 - in Zone 2
 - in Zone 21 and Zone 22
- For installation as
 - Pendant light fitting
 - Pole-mounting light fitting
 - Bulkhead light fitting



- With electronic ballast (1- or 2-channel)
- For two pin fluorescent lamps
- 1- or 2-lamp version: 18 W, 36 W or 58 W
- Enclosure in polyester resin, glass fibre reinforced and cover in polycarbonate, impact-resistant
- Quick fasteners

To learn more about B-I-A please visit us at our
WEB site: www.BiaGmbH.com



Selection table

Version	Lamps	Electronic ballast	Ordering code	Weight kg
Series 6600 for use in Zone 2, Zone 21, Zone 22	1 x 18 / 20 W	1-channel	6600/521-8...-2..0	2,500
	2 x 18 / 20 W	1-channel	6600/522-8...-2..0	2,500
	2 x 18 / 20 W	2-channel	6600/522-9...-2..0	2,900
	1 x 36 / 40 W	1-channel	6600/541-8...-2..0	4,600
	2 x 36 / 40 W	1-channel	6600/542-8...-2..0	4,600
	2 x 36 / 40 W	2-channel	6600/542-9...-2..0	5,000
	1 x 58 / 65 W	1-channel	6600/561-8...-2..0	5,800
	2 x 58 / 65 W	1-channel	6600/562-8...-2..0	5,800
	2 x 58 / 65 W	2-channel	6600/562-9...-2..0	6,200

Add. to ordering code

Through wiring	Standard: without	6600/.....0.....
	Special: with 3 cores	6600/.....3.....
	Special: with 5 cores	6600/.....5.....
Cable entries	Standard: M 25 x 1,5 1 cable entry 2 plugs	6600/.....1.....
	Special: M 20 or M 25 moulded of plastic or metal State with order	6600/.....9.....
	Switching off	Standard: without 6600/.....0..... Special: With 8080 switch, 2-pole 6600/.....1.....
Connection terminal type	Standard: screw terminals max. 4 mm ²	6600/.....-1..
	Special: tension clamp terminals max. 2,5 mm ²	6600/.....-2..
	Special: screw terminals max. 6 mm ²	6600/.....-3..
Connection terminal number	Standard: 3 (L1, N, PE)	6600/.....-3..
	Special: 5 (L1, L2, L3, N, PE)	6600/.....-5..
Note	The light fittings are supplied without tubes and mounting accessories. These parts must be ordered separately.	

Technical Data

Explosion protection

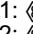
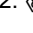
Gas explosion protection	for Zone 2  II 3 G EEx nA II T4
Dust explosion protection	for Zone 21:  II 2D IP66 T 80 °C* for Zone 22:  II 3D IP66 T 80 °C*
	* T 80 °C = max. surface temperature referred to
	18 W, 36 W: T _a = + 55 °C
	58 W: T _a = + 45 °C

Certificates

for gas explosion protection	Zone 2 DMT 01 E 085
for dust explosion protection	Zone 21 DMT 01 ATEX E 086X Zone 22 DMT 01 E 085

Marking

CE 0102

Lamps

Two pin-fluorescent lamps \varnothing 26 mm or \varnothing 38 mm, socket G13
1 x 18 W, 2 x 18 W, 1 x 36 W, 2 x 36 W, 1 x 58 W, 2 x 58 W

Technical Data

Rated Voltage	AC: 198 V ... 264 V 50 / 60 Hz DC: 154 V ... 276 V		
Rated current	at 230 V / 50 Hz		
	1 x 18 / 20 W	1 x 36 / 40 W	1 x 58 / 65 W
	0,08 A	0,16 A	0,31 A
	2 x 18 / 20 W	2 x 36 / 40 W	2 x 58 / 65 W
	0,16 A	0,25 A	0,48 A
Power factor cos φ	cos . = 0,98 capacitive No additional compensation required		
Ambient temperature	– 20 °C ... + 55 °C (18 W / 36 W) – 20 °C ... + 45 °C (58 W)		
Efficiency of light	Wide beam		
	1 x 18 / 20 W	1 x 36 / 40 W	1 x 58 / 65 W
	80 %	80 %	80 %
	2 x 18 / 20 W	2 x 36 / 40 W	2 x 58 / 65 W
	74 %	74 %	74 %
Material			
Housing	Polyester resin, glass-fibre reinforced, colour white, similar RAL 9010		
Cover	Polycarbonate; protective paint possible		
Gaskets	Polyurethane-gasket foamed into diffuser		
Quick-action fasteners	Polyamide, glass-fibre reinforced, black / white		
Installations parts	Polyester resin, glass-fibre reinforced, colour white, similar RAL 9010		
Protection class	I (with internal PE connection terminal)		
Cover fixing	Quick fasteners to open with screw-driver; cover hinged for access.		
Light guides	Standard	Wide beam, reflector painted white. Colour: signal white RAL 9003; prismatic structure for anti-glare in the diffuser sides.	
	Special	Additional reflector (easily mounted), broad deep-beam, aluminium anodized and semi-polished.	
Connection	Standard	Screw terminals clamping area: 2 x 4 mm ² (fine wire / single wire) 3-pole (marking: L1 + N + PE)	
	Special:	Cage clamping spring clamping area. 2 x 2,5 mm ² 5-pole (marking: L1 + L2 + L3 + N + PE) or Terminal block with screw terminals in polyamide also with additional connection points for through wiring cable dia range: max. 2 x 6 mm ² (single core) max. 2 x 4 mm ² (flexible) 3-pole (terminal marking: L1 + N + PE) 5-pole (terminal marking: L1 + L2 + L3 + N + PE)	
Thengh wiring	Standard:	1 x compression gland 8161, M 25 x 1,5; cable dia. range: 7 ... 17 mm 2 x plugs 8290, M 25 x 1,5	
	Special:	Entry parts in moulded plastic (8161/8290): M 20 Metal glands: M 20; M 25; Metal cable gland earthing via metal adapter plates	
Switch-off		optional	
	On opening the diffuser	when opening the fastening mechanism of one of the quick fasteners, voltage to ballast will be switched off all-pole; contacts are positively opening, reconnection when cover and quick fasteners are closed.	
	Faulty lamp	If lamp is faulty, power supply of lamps is switched off automatically by electronic ballast; when using a 2-channel-ECG power is switched off only to the defective lamp.	

Technical Data

Luminous intensity distribution

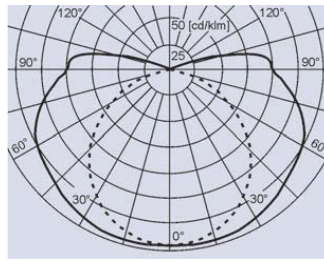

Version 1-lamp, without reflector
Accuracy class acc. to LitG B21

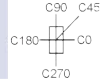
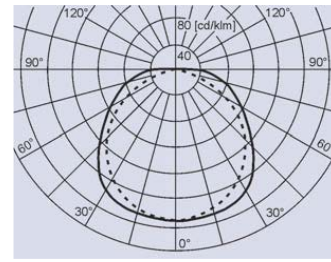

1-lamp, with reflector
B31

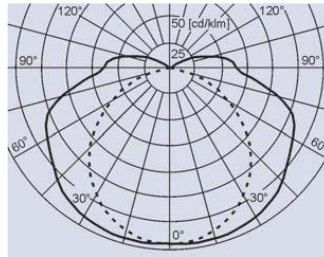

Version 2-lamp, without reflector
Accuracy class acc. to LitG B21

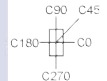
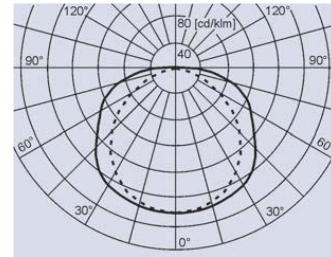

2-lamp, with reflector
B31

Installation notes

- Looping through of cables There are 2 M 25 x 1,5 cable entries on the connection side for looping through of connection cable (entry and exit on one side).
- Through wiring Fittings can be supplied with internal through-wiring. Entry and exit holes for connection cables are positioned on opposite sides. A through-wiring kit can be fitted after manufacture (see accessories).
Terminals: See technical data top
Wiring cross-section: 2,5 mm² for max. 16 A
- Mounting
 - Standard 2 x M8 inserts in housing
 - Special Mounting grooves in housing to accommodate bracket fitting and ceiling rails for variable light installation.
Variable mounting distances of light fittings; see dimension drawings

To learn more about B-I-A please visit us at our
WEB site: www.BiaGmbH.com



Dimension drawings (all dimensions in mm) - subject to alterations

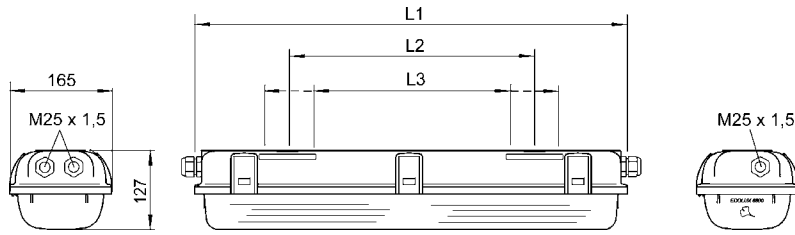

Dimensions	Light fitting		
	18 / 20 W	36 / 40 W	58 / 65 W
L1	700	1310	1610
L2 1)	400	800	800
L3 2)	340 ... 460	680 ... 920	795 ... 1030

1) Fixed mounting distance
2) Variable mounting distance

Light fittings ECOLUX 6600, 18 W, 36 W, 58 W

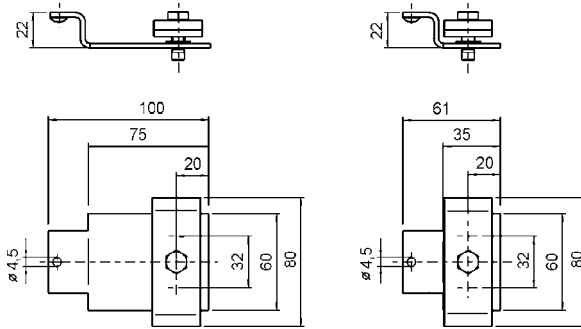
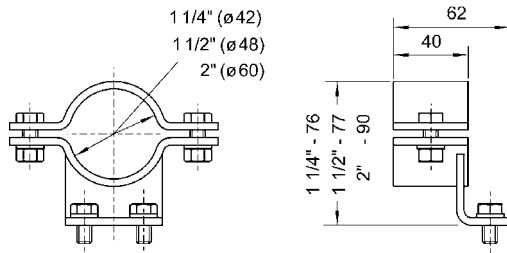

Pipe clamp

Mounting set grid cable rack

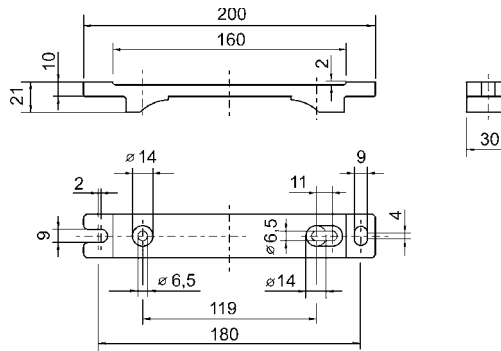
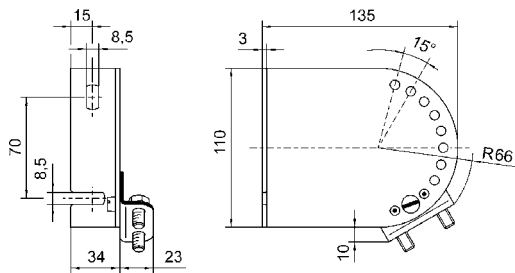

Ceiling- and wall-mounting bracket

Ceiling mounting bracket

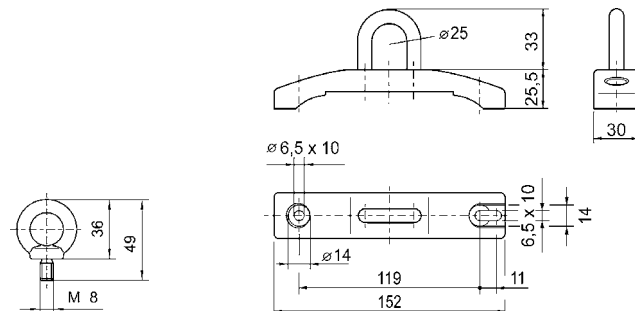
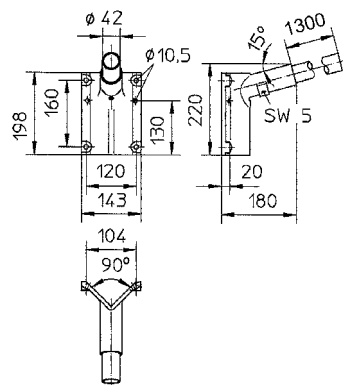





Wall mounting bracket for pole-mounting version

Ring bolt

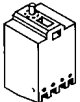

Mounting clamp bracket

Installation accessories

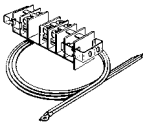

Accessories and spare parts

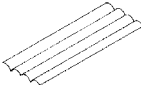
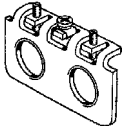
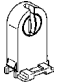
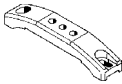
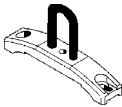
Designation	Illustration	Description	Ordering code	Weight kg
Fluorescent lamp		Two pin base \varnothing 26 mm Light colour: Universal white		
		18 W 1100 lm	4617220	0,100
		36 W 2600 lm	4617210	0,200
Diffuser cover		For lamp 18 / 20 W	6600001050	2,000
		For lamp 36 / 40 W	6600002050	0,600
		For lamp 58 / 65 W	6600003050	1,000
Switch		Switch element 8080/1-3-L, 2 NC	8080006600	0,025
Ballast		1 x 18 W 1-channel	3657680	0,276
		2 x 18 W 1-channel	3657710	0,700
		1 x 36 W 1-channel	3657690	0,292
		2 x 36 W 1-channel	3657720	0,345
		1 x 58 W 1-channel	3657700	0,300
		2 x 58 W 1-channel	3657730	0,400
Mounting kit for through wiring		For later installation into standard-light fitting		
		DV3, tension clamp terminals 3 x 2,5 mm ² , max. 16 A terminal marking: L1 + N + PE		
		18 W / 20 W	6600810870	0,300
		36 W / 40 W	6600811870	0,300
		58 W / 65 W	6600812870	0,300
		DV5, tension clamp terminals 5 x 2,5 mm ² , max. 16 A terminal marking: L1 + L2 + L3 + N + PE		
		18 W / 20 W	6600807870	0,300
		36 W / 40 W	6600808870	0,300
		58 W / 65 W	6600809870	0,300
		DV3, screw terminals 3 x 2,5 mm ² , max. 16 A terminal marking: L1 + N + PE		
		18 W / 20 W	6600804870	0,400
		36 W / 40 W	6600805870	0,400
58 W / 65 W	6600806870	0,400		
DV5, screw terminals 5 x 2,5 mm ² , max. 16 A terminal marking: L1 + L2 + L3 + N + PE				
18 W / 20 W	6600801870	0,400		
36 W / 40 W	6600802870	0,400		
58 W / 65 W	6600803870	0,400		

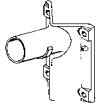
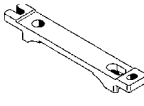
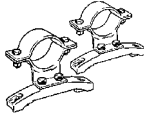
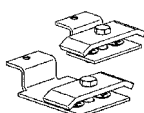
Accessories and spare parts

Designation	Illustration	Description	Ordering code	Weight kg	
Reflectors		For later installation, broad deep-beam			
		For 1-lamp light fittings 18 W / 20 W	6030903580	0,082	
		For 1-lamp light fittings 36 W / 40 W	6030904580	0,172	
		For 1-lamp light fittings 58 W / 65 W	6030906580	0,218	
		For 2-lamp light fittings 18 W / 20 W	6030901580	0,110	
		For 2-lamp light fittings 36 W / 40 W	6030902580	0,234	
		For 2-lamp light fittings 58 W / 65 W	6030905580	0,290	
Adapter plates		For earthing continuity when metal glands are used			
		1 x M 20 x 1.5	1 pc	6000815550	0,070
		1 x M 25 x 1.5	1 pc	6000816550	0,070
		1 x NPT 1/2"	1 pc	6000817550	0,070
		1 x NPT 3/4"	1 pc	6000818550	0,070
		2 x M 20 x 1.5	1 pc	6000819550	0,060
		2 x M 25 x 1.5	1 pc	6000820550	0,060
2 x NPT 1/2"	1 pc	6000821550	0,060		
Lamp-holder		Lamp-holder for 2-pin base lamps G 13	3856630	0,020	
Mounting rail		For variable mounting 1 pair	6600801750	0,420	
Mounting clamp bracket		Installation clamp mounted on installation rail for variable mounting distances	1 pair	6600802750	0,010
M8 ring bolts		M 8, to mount directly into inserts, 1 pair	6000803900	0,100	
Wall-mounting bracket		For pole-mounting fitting with extension tube 1300 mm in length, Ø 42 mm (for pipe clamp R1 1/2")	4637490	6,000	
Ceiling mounting bracket		For ceiling mounting of light fitting 1 pair	6600803750	0,230	
Pipe clamps		with mounting rail for variable mounting distances; material: stainless steel			
		R 1 1/4" (Ø 42 mm)	6600805260	1,000	
		R 1 1/2" (Ø 48 mm)	6600801260	0,050	
		R 2" (Ø 60 mm)	6600802260	0,050	
Mounting set „Grid cable rack”		For grid cable racks, with wire diameter 6 mm; with mounting rail for variable mounting distance; Material: Stainless steel	6600803260	0,775	

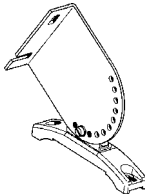
Accessories and spare parts

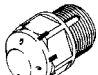
Designation	Illustration	Description	Ordering code	Weight kg	
Ceiling and wall-mounting bracket		With mounting rail for variable mounting distances; Material: Stainless steel Lamp can be swivelled in steps of 15° 1 pair	6600804260	1,200	
Cable gland		in moulded plastic			
		8161/5-M 25 x 1,5	1 piece	8161077010	0,011
		8161/5-M 20-13	50 pieces	8161025030	0,011
		8161/5-M 25 x 1,5	1 piece	8161078010	0,016
Stopping plug		in moulded plastic			
		8290/3-M 20 x 1,5	1 piece	8290008590	0,004
		8290/3-M 20 x 1,5	100 pieces	8290045590	0,600
		8290/3-M 25 x 1,5	1 piece	8290009590	0,006
Breathing gland		for installation in light fittings; in moulded plastic; without locknut			
		Thread: M 25 x 1,5	1 unit	8162001020	0,010
		Thread: M 25 x 1,5	20 units	8162002020	0,200

We reserve the right to make alterations to the technical data, weights, dimensions, designs and products available without notice. The illustrations cannot be considered binding.

To learn more about B-I-A please visit us at our
WEB site: www.BiaGmbH.com

