

## Europe - Mains Appliance Line Socket 70°C / 16 Amp.

### SPECIFICATIONS

- Mains Appliance Line Socket 70°C / 16A, Grounding Contact, Rewireable, Strain Relief
- Ratings: 16A / 250V AC
- Standard: DIN EN 60320-1 / C19
- Terminals: Screw-Type
- Contacts: CuZn 37
- Parts & Housing: Polyamide 6
- Approvals: ENEC, VDE



Catalog No.	Ratings	Color	Description (Wire Types)	VPE/Pack	EDP-No.
763BK	70°C, 16A-250V AC	Black	H05VV-F and H05RR-F 3G1.0mm <sup>2</sup> and 3G1.5mm <sup>2</sup> Wire Stripping: Neutral, Line and Ground 20.0mm	100 ea	122550

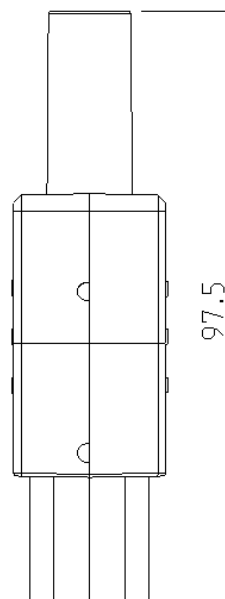
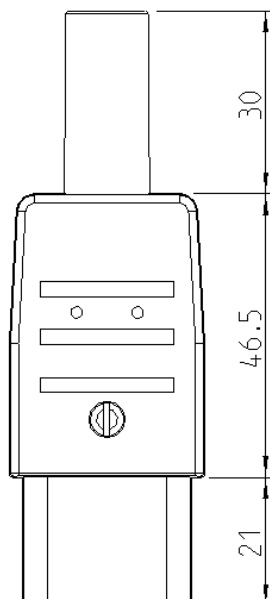
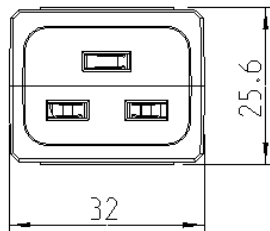

## Europe - Mains Appliance Line Plug 70°C / 16 Amp.

### SPECIFICATIONS

- Mains Appliance Line Plug 70°C / 16A, Grounding Contact, Rewireable, Strain Relief
- Ratings: 16A / 250V AC
- Standard: DIN EN 60320-1 / C20
- Terminals: Screw-Type
- Contacts: CuZn 39
- Carrying Parts: Polyamide 6 V0
- Housing: Polyamide 6
- Approvals: ENEC, VDE



Catalog No.	Ratings	Color	Description (Wire Types)	VPE/Pack	EDP-No.
765BK	70°C, 16A-250V AC	Black	H05VV-F and H05RR-F 3G1.0mm <sup>2</sup> and 3G1.5mm <sup>2</sup> Wire Stripping: Neutral and Line 35.0mm, Ground 45.0mm	100 ea	122559

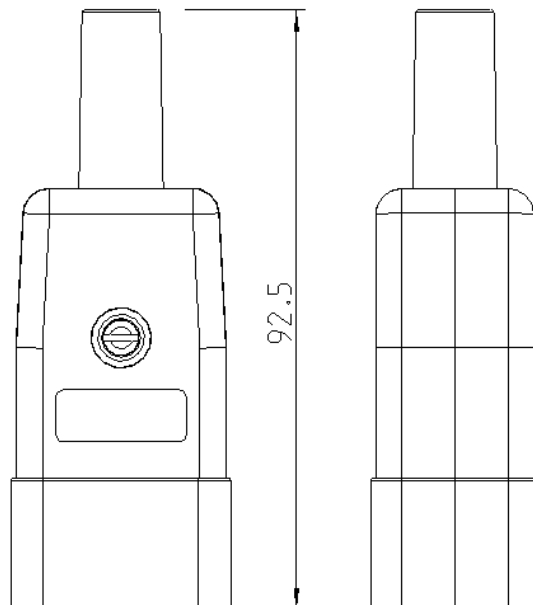
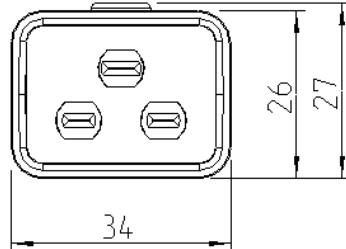

## Europe - Mains Appliance Outlet 70°C / 16 Amp.

### SPECIFICATIONS

- Mains Appliance Outlet 70°C / 16A with Grounding Contact
- Ratings: 16A / 250V AC
- Standard: DIN EN 60320-1 / C19
- Terminals: Screw-Type, Quick Connetct
- Contacts: CuZn 37
- Carrying Parts: Polyamide 6 V0
- Housing: Polyamide 6 V0
- Approvals: ENEC, VDE



Catalog No.	Ratings	Color	Description	VPE/Pack	EDP-No.
766BK	70°C, 16A-250V AC	Black	Screw-Type Terminals (Standard Version)	100 ea	122556
766BK48	70°C, 16A-250V AC	Black	Quick Connect Terminals 4.8mm	100 ea	122557
766BK63	70°C, 16A-250V AC	Black	Quick Connect Terminals 6.3mm	100 ea	122558

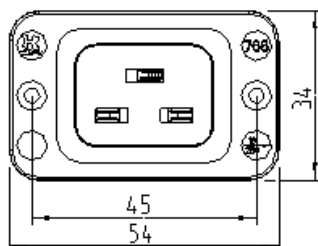
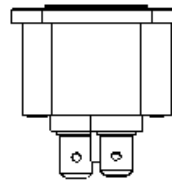
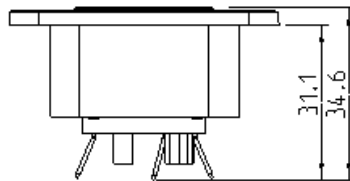
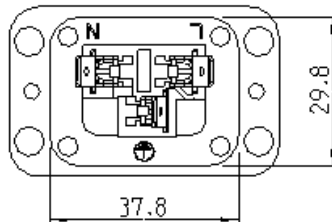

## Europe - Mains Appliance Inlet 70°C / 16 Amp.

### SPECIFICATIONS

- **Mains Appliance Inlet 70°C / 16A with Grounding Contact**
- **Ratings:** 16A / 250V AC
- **Standard:** DIN EN 60320-1 / C20
- **Terminals:** Screw-Type, Quick Connetct
- **Contacts:** CuZn 37
- **Carrying Parts:** Polyamide 6 V0
- **Housing:** Polyamide 6 V0
- **Approvals:** ENEC, VDE



Catalog No.	Ratings	Color	Description	VPE/Pack	EDP-No.
<b>767BK</b>	70°C, 16A-250V AC	Black	Screw-Type Terminals (Standard Version)	100 ea	<b>122553</b>
<b>767BK48</b>	70°C, 16A-250V AC	Black	Quick Connect Terminals 4.8mm	100 ea	<b>122552</b>
<b>767BK63</b>	70°C, 16A-250V AC	Black	Quick Connect Terminals 6.3mm	100 ea	<b>122343</b>

