

## Snap-N-Service









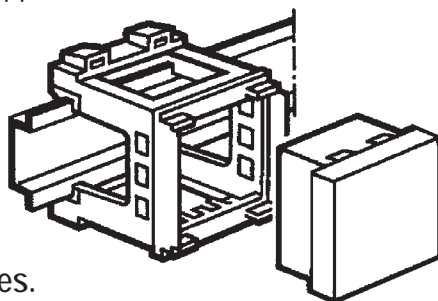

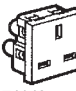

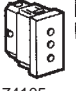



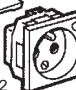

*Put a Service Outlet to Your Cabinet...*

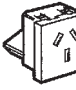
### Features:

- Multi standard range unlimited possibilities.
- Various international outlets available.
- DIN-Rail support frame available.
- Used to put a service outlet to cabinets or any other equipment.
- Saves installation time and additional stocking charges.
- Metallclad surface boxes permits the mounting of modules directly.
- Snap-In modules provides various applications.
- International certifications where applicable.

Modules available for:  
 Argentina, Australia, Belgium,  
 Canada, China, Denmark,  
 France, Germany, Israel,  
 Italy, Poland, Switzerland,  
 United Kingdom, U.S.A.  
 Combination Units & Accessories.

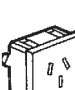

Document	Catalog No. / Katalog-Nr.	Description / Beschreibung	Weight/ea	VPE/Pack	U/M	EDP-No.
<b>2314</b>	<b>Continental Europe Snap-In Modul Mechanisms, (45x45)mm or (22.5x45)mm</b>					
	<b>74140</b> (GB)	British Standard, BS 1363, 250Vac, 13A, 2P+E, White	38 g	100/10	ea	<b>112912</b>
	<b>74130</b> (D)	Germany (SCHUKO), Shuttered, 250Vac, 16A, 2P+E, White	37 g	200/10	ea	<b>115407</b>
	<b>74133</b> (D)	Germany (SCHUKO), with Closing Lid, 250Vac, 16A, 2P+E, White	39 g	100/10	ea	<b>117578</b>
	<b>74105</b> (I)	Italy, Shuttered for Child Safety, 250Vac, 10A, 2P+E, White	26 g	100/10	ea	<b>116102</b>
	<b>74106</b> (I)	Italy, Shuttered for Child Safety, 250Vac, 10/16A, 2P+E, White	26 g	100/10	ea	<b>112916</b>
	<b>74169</b> (CH)	Switzerland Typ 13, Shuttered, 250Vac, 10A, 2P+E, White	25 g	100/10	ea	<b>112910</b>
	<b>74111</b> (F)(B)	France/Belgium/Poland, with Shutters, 250Vac, 10/16A, 2P+E, White	36 g	200/10	ea	<b>112908</b>
	<b>74112</b> (F)(B)	France/Belgium/Poland, w/Neon/Shutters, 250Vac, 10/16A, 2P+E, White	41 g	100/10	ea	<b>114686</b>
	<b>74116</b> (F)(B)	France/Belgium/Poland, w/Lid/Shutters, 250Vac, 10/16A, 2P+E, White	43 g	100/10	ea	<b>114172</b>
<b>2317</b>	<b>North America, Japan, South America Snap-In Modul Mechanisms, (45x45)mm or (22.5x45)mm</b>					
	<b>74180</b> (USA)(CDN)	USA/Canada/Japan, NEMA 5-15R, 127Vac, 15 Amp., 2P+E, White	39 g	100/10	ea	<b>112909</b>
	<b>74101</b> (US/EU) 2P	USA/Brazil/Europe, 127/250Vac, 15/16A, 2P Non-Grounding, White	23 g	100/10	ea	<b>116100</b>
	<b>74102</b> (US/EU)	USA/South America/Europe, 127/250Vac, 15/16A, 2P+E, White	42 g	100/10	ea	<b>117716</b>
<b>2316 2349 2310</b>	<b>Various Snap-In Modul Mechanisms, (45x45)mm</b>					
	<b>74167</b> (AUS)	Australia, 250Vac, 10A, 2P+E, White	33 g	100/10	ea	<b>112913</b>
	<b>19472</b> (DK)	Denmark, 250Vac, 13A, 2P+E, White	29 g	100/10	ea	<b>119207</b>
	<b>19465</b> (DK-DATA)	Denmark, EDB, 250Vac, 13A, 2P+E, White	27 g	100/10	ea	<b>119208</b>
	<b>74152</b> (ROC)	China, with Shutters, 250Vac, 10A, 2P+E, White	36 g	100/10	ea	<b>117717</b>
	<b>74153</b> (ROC)	China, with Shutters, 250Vac, 16A, 2P+E, White	45 g	100/10	ea	<b>117718</b>
	<b>74174</b> (IL)	Israel, 250Vac, 16A, 2P+E, White	32 g	100/10	ea	<b>117719</b>
	<b>74175</b> (IL)	Israel, dedicated, 250Vac, 16A, 2P+E, White	43 g	100/10	ea	<b>117760</b>
	<b>74170</b> (ARG)	Argentina, 250Vac, 10A, 2P+E, White	34 g	100/10	ea	<b>117720</b>
	<b>74171</b> (ARG)	Argentina, 250Vac, 20A, 2P+E, White	34 g	100/10	ea	<b>117721</b>

### Cat.No. 74872

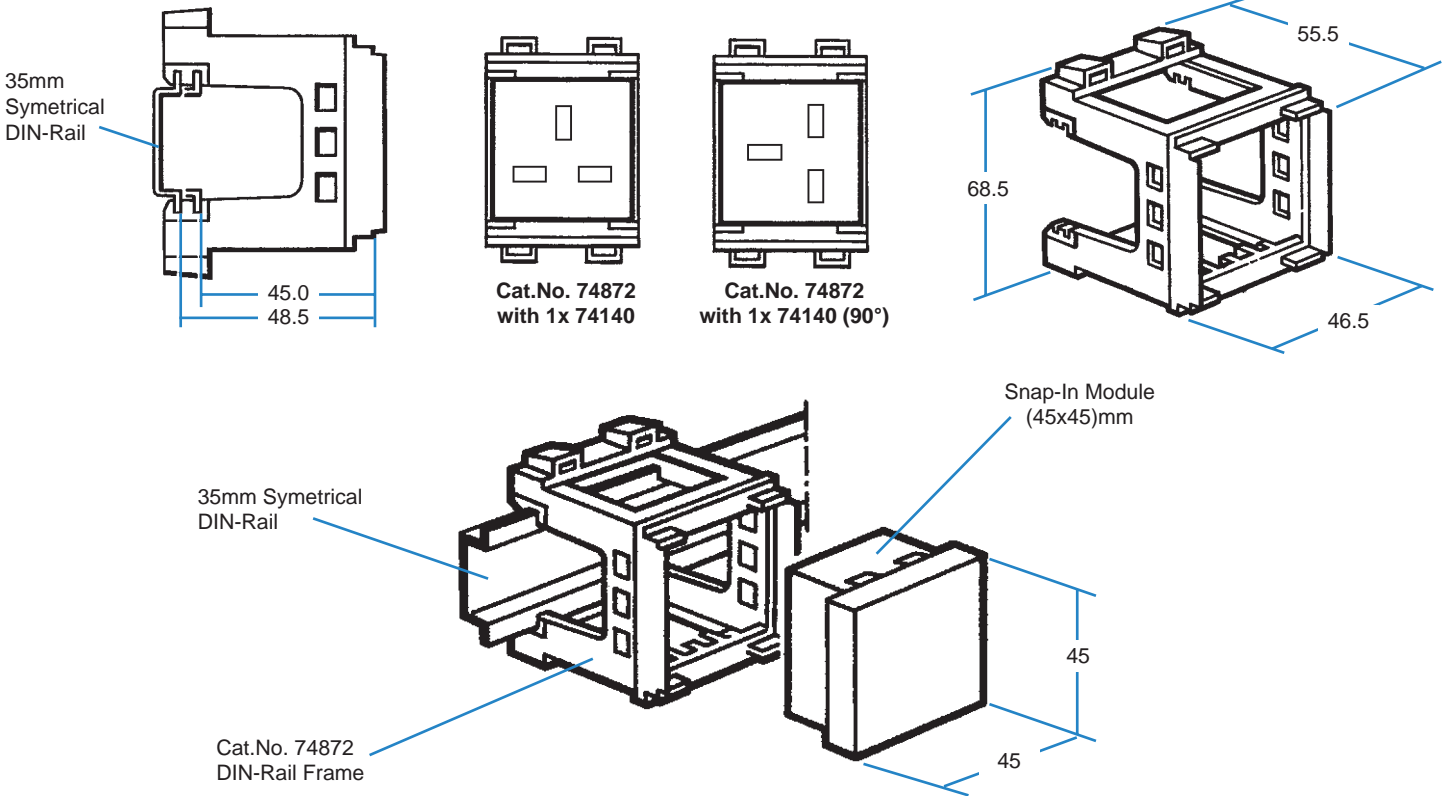

Document	Catalog No. / Katalog-Nr.	Description / Beschreibung	Weight/ea	VPE/Pack	U/M	EDP-No.
----------	---------------------------	----------------------------	-----------	----------	-----	---------

<b>2314</b> <b>2317</b> <b>2319</b>	<b>Blanking Plate Snap-In Modul Mechanisms, (45x45)mm or (22.5x45)mm</b>					
-------------------------------------	--	--	--	--	--	--



<b>74391</b>	Blanking Plate (22.5x45)mm, Plastic, White	5 g	100/10	ea	<b>115976</b>
<b>74392</b>	Blanking Plate (45x45)mm, Plastic, White	11 g	100/10	ea	<b>117761</b>

Document	Catalog No. / Katalog-Nr.	Description / Beschreibung	Weight/ea	VPE/Pack	U/M	EDP-No.
----------	---------------------------	----------------------------	-----------	----------	-----	---------

<b>2223</b> <b>2538</b>	<b>Surface Boxes for Snap-In Modul Mechanisms</b>					
<b>81178</b>	Surface Metalclad Box (82x82x44)mm, ø 20mm conduit entries, All boxes includes grid with earth terminal. for Use with One (22.5x45)mm Module, Gray	224 g	50/5	ea	<b>117772</b>	
<b>81179</b>	for Two (22.5x45)mm Modules, or One (45x45)mm Module, Gray	207 g	50/5	ea	<b>117773</b>	
<b>81183</b>	Surface Metalclad Box (143x82x44)mm, Two (45x45) Module, Gray	316 g	25/5	ea	<b>117774</b>	
<b>89314</b>	Surface Plastic Box, White, Depth 30mm, (80x80)mm	34 g	100/5	ea	<b>117875</b>	
<b>89320</b>	Surface Plastic Box, White, Depth 40mm, (80x80)mm	43 g	100/5	ea	<b>117866</b>	
<b>74802</b>	Screw Mount Module Support Frame, Used w/Cat. # 89314 or 89320	27 g	400/20	ea	<b>117867</b>	
<b>75002</b>	Plastic Cover Plate, White, (80x80)mm, Used with Cat.No. 74802	18 g	200/20	ea	<b>117868</b>	

Document	Catalog No. / Katalog-Nr.	Description / Beschreibung	Weight/ea	VPE/Pack	U/M	EDP-No.
----------	---------------------------	----------------------------	-----------	----------	-----	---------

<b>74872</b>	<b>DIN-Rail Mounting Frame for Modular Devices</b>	Snap-On Mounting Frame for Symmetrical 35mm DIN-Rail, Plastic, White, Support for Two (22.5x45)mm Modules, or One (45x45)mm Module, Dimensions: Width 46.5mm x 68.5mm x Height 55.5mm	17 g	200/10	ea	<b>112911</b>
--------------	--	---	------	--------	----	---------------

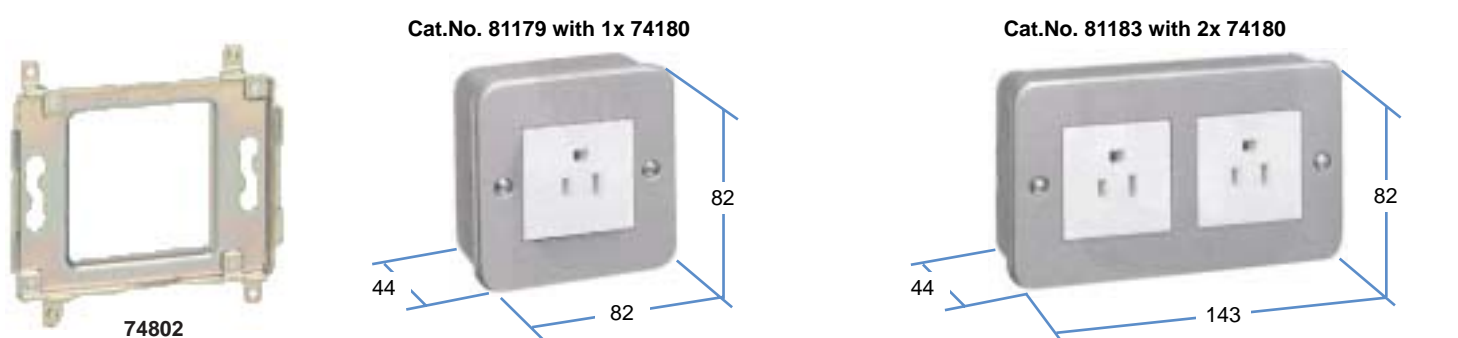

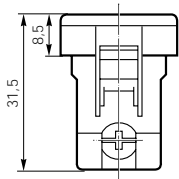

74101

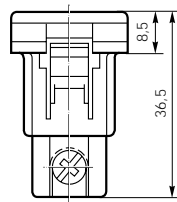

74105 + 74106

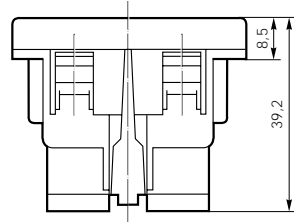

74130

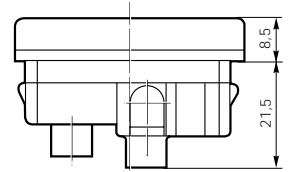

74140

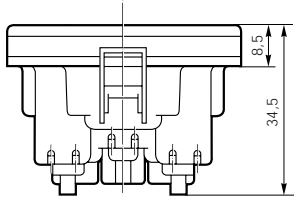

74169

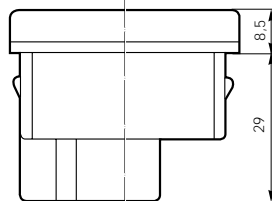

74167

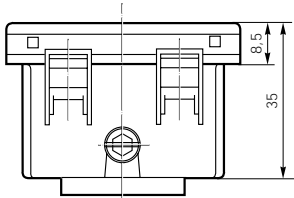

74180

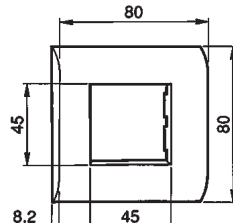

75002

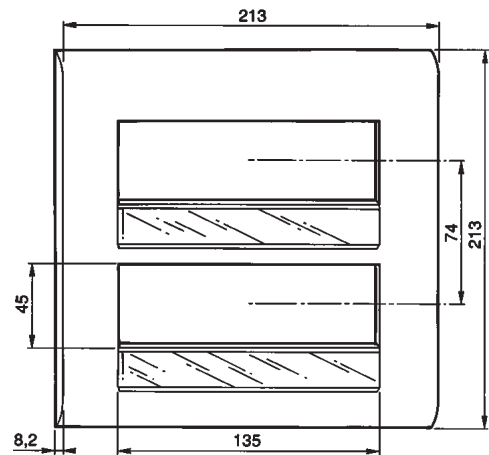

75042

Document	Catalog No. / Katalog-Nr.	Description / Beschreibung	Weight/ea	VPE/Pack	U/M	EDP-No.
----------	---------------------------	----------------------------	-----------	----------	-----	---------

**117867 Modul Cover and Support Frame for 6 (45x45)mm or 12 (22.5x45)mm Modules**

<p>74825</p>	<b>74825</b>	Metal Frame for 2 x 6 Modules, Horizontal Screw Mounting	266 g	25/5	ea	<b>121200</b>
	<b>75042</b>	Plastic Plate, White, for 2 x 6 Modules (22.5x45)mm, or 2 x 3 Modules (45x45)mm, Horizontal Mounting, Clipped on using slats for reduced thickness, With label holder Dimensions (213x213)mm	112 g	25/5	ea	<b>121201</b>

Further Frames and Cover Plates can be found in [Document #117867](#)

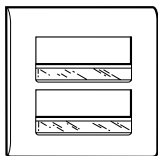

75042

To learn more about B-I-A please visit us at our  
WEB site: [www.BiaGmbH.com](http://www.BiaGmbH.com)

