



Threaded Adapters NPT / Metric Ms-Ni

Used to convert North American NPT threads to European METRIC threads.

Material: Nickel Plated Brass

Catalog Number	A (NPT)	B	C	D	E	SW	Dia.	Weight/ea	VPE/Pack	EDP-No.
1/2" NPT-M20	1/2"	M20x1.5	17.0	21.0	14.7	23.0	27.0	53 g	50 ea	120182
3/4" NPT-M25	3/4"	M25x1.5	17.0	21.0	19.8	30.0	35.0	89 g	50 ea	120183
1" NPT-M32	1"	M32x1.5	17.0	21.0	25.8	37.0	43.0	122 g	50 ea	120184

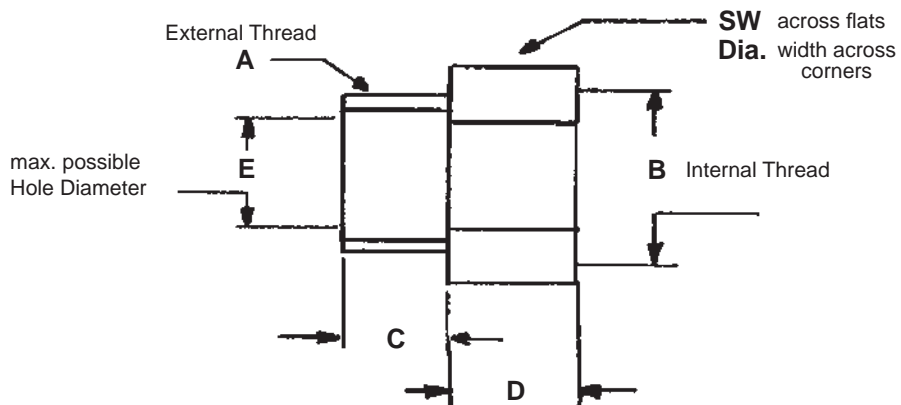

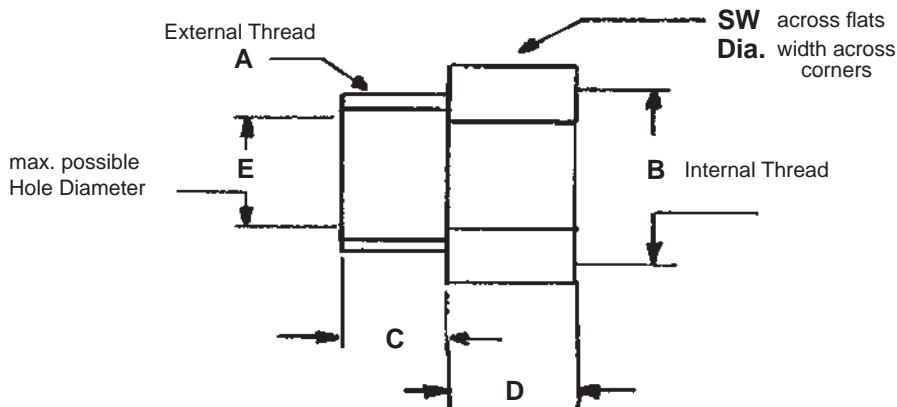

Threaded Adapters NPT / Metric Ms-Ni

Used to convert North American NPT threads to European METRIC threads.

Material: Nickel Plated Brass

Catalog Number	A (NPT)	B	C	D	E	SW	Dia.	Weight/ea	VPE/Pack	EDP-No.
1/2"NPT-M16	1/2"	M16x1.5	17.0	3.7	—	23.0	26.8	30 g	—	120179
1-1/4"NPT-M40	1-1/4"	M40x1.5	17.4	5.5	—	47.0	54.1	205 g	—	120545
2-1/2"NPT-M16	2-1/2"	M16x1.5	28.0	8.3	—	80.0	92.0	640 g	—	120546
2-1/2"NPT-M40	2-1/2"	M40x1.5	28.0	8.3	—	80.0	92.0	555 g	—	120547
2-1/2"NPT-M50	2-1/2"	M50x1.5	28.0	8.3	—	80.0	92.0	510 g	—	120548